



BASECAMP

DESOLATION SOUND

RARE ECO-ACREAGES AT THE ENTRANCE
TO DESOLATION SOUND

IMPORTANT FACTS ABOUT BASECAMP

400

**METRES OF SECLUDED
BEACHFRONT**

3 to 7

**ACRE BARE LAND STRATA
FREEHOLD PARCELS**



ACCESS BY **CAR & BOAT**

H2O

**PARCELS PRE-SERVICED
WITH PRIVATE WELL**



**LEGALLY SEPARATED MULTI-
OWNER PARCELS**



**FULL BC HYDRO
SERVICE**

12

**PARCELS RELEASED IN
FOUNDERS SALE**

150

PRISTINE ACRES



A RARE AND SECLUDED WILDERNESS

Escape to your acreage at the tip of the Sunshine Coast Trail and overlooking the entrance to Desolation Sound. Accessible by car or by boat. Rare indeed for this special corner of the world.

Surrounded by the natural beauty of mountain and ocean views with fir, arbutus and alder trees, and scented by the fresh sea-air.

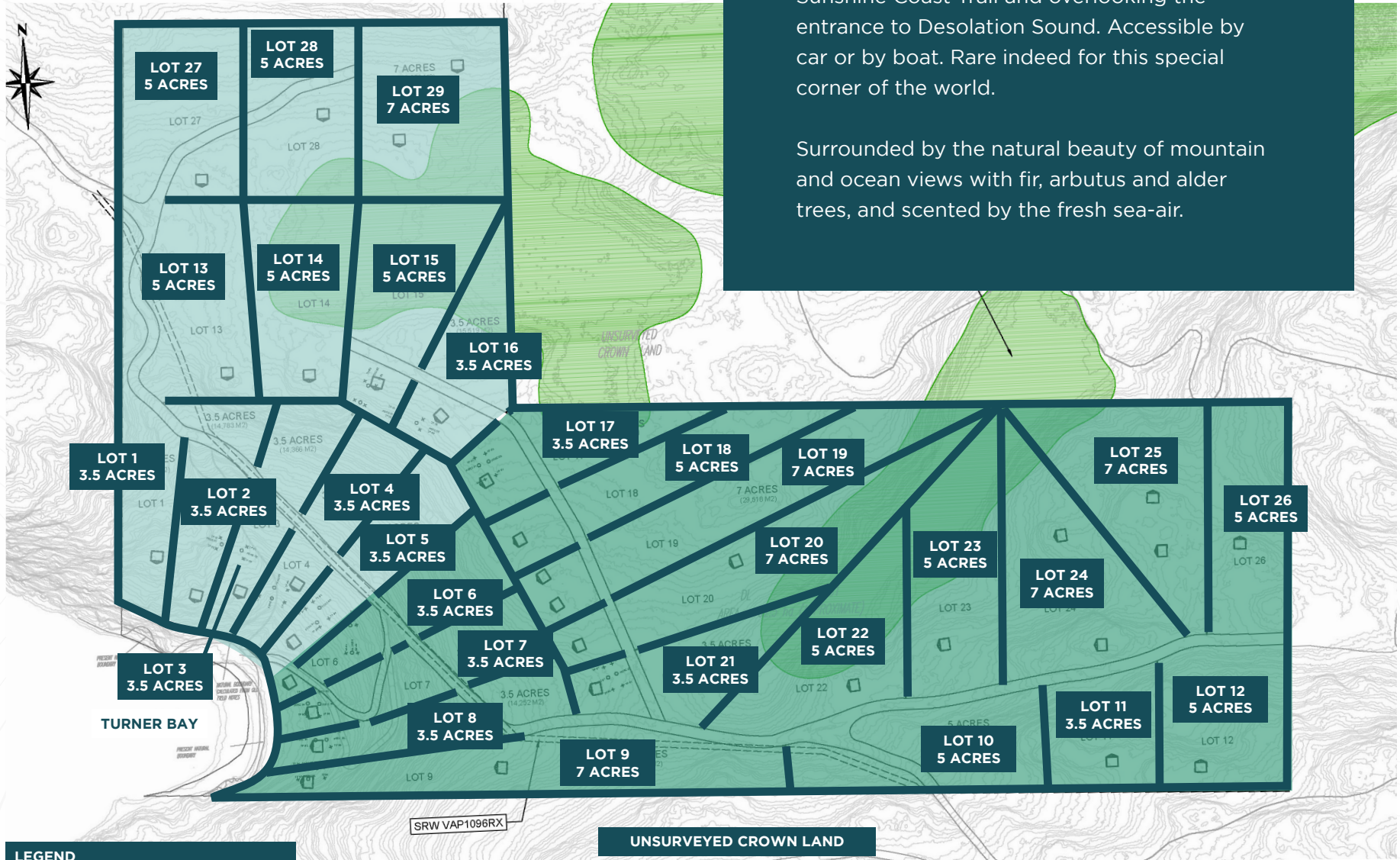

LEGEND

- = 120 M²
- FOUNDERS RELEASE (12 LOTS)
- SECOND RELEASE

WOODED WONDERLANDS

There are only 29 freehold, bare land strata acreages at BaseCamp, and just 12 to be released this Fall. Most with commanding views of the Salish Sea Desolation Sound. Others fronting the private beach. All with access to 400 metres of pristine private beachfront.



RETREAT TO HERE & LAUNCH FROM HERE

If you know, you know. This special corner of the world is unparalleled in its beauty, and its offering of both recreational opportunities, and opportunities to escape. Boating, Biking, Hiking boots, kayaks, SUPs, campfires, memories and quiet retreats are found here.

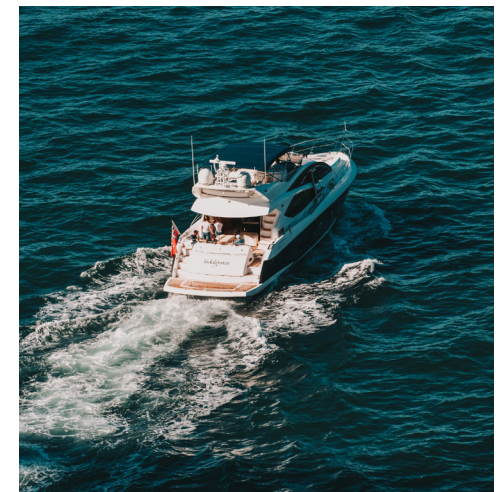

**A. HERNANDO
ISLAND**

**B. TWIN
ISLAND**

**C. CORTEZ
ISLAND**



**ESCAPE TO YOUR ACREAGE AT THE
TIP OF THE SUNSHINE COAST TRAIL
AND OVERLOOKING THE ENTRANCE
TO DESOLATION SOUND.**



BASECAMP
DESOLATION SOUND