



# basecamp desolation sound

**own.  
dock.  
build.**

**Exclusive pre-paid moorage  
& freehold building parcels**

 *next to Desolation Sound*



# 3-7 ACRE PARCELS

*Oceanfront*



*Oceanview*



*Wilderness*

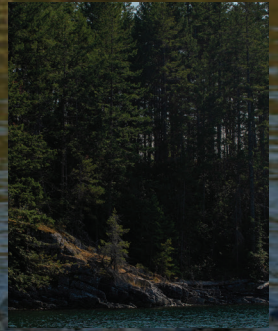

## COMING VERY SOON

- Private Moorage
- No Building Permits required
- Road Access from Lund



Private moorage &  
6 new building parcels  
coming soon.



# Escape to your acreage



basecamp  
desolation sound

PARCEL 10



14,822 m<sup>2</sup>  
1.48 ha  
3.66 ac

PROPERTY LINE  
SETBACK LINE  
TOPO ELEVATION (m)



basecamp  
desolation sound

PARCEL 11



14,642 m<sup>2</sup>  
1.46 ha  
3.62 ac

PROPERTY LINE  
SETBACK LINE  
TOPO ELEVATION (m)



basecamp  
desolation sound

PARCEL 16



15,892 m<sup>2</sup>  
1.59 ha  
3.93 ac

PROPERTY LINE  
SETBACK LINE  
TOPO ELEVATION (m)



basecamp  
desolation sound

PARCEL 18



21,277 m<sup>2</sup>  
2.13 ha  
5.26 ac

PROPERTY LINE  
SETBACK LINE  
TOPO ELEVATION (m)

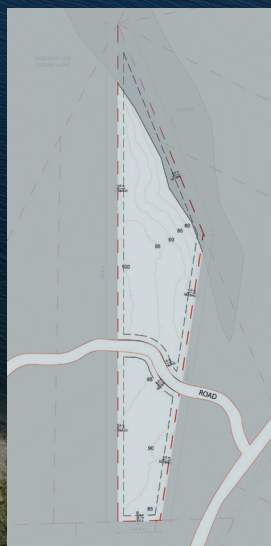

basecamp  
desolation sound

PARCEL 20



29,762 m<sup>2</sup>  
2.98 ha  
7.35 ac

PROPERTY LINE  
SETBACK LINE  
TOPO ELEVATION (m)

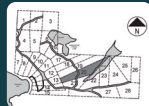

basecamp  
desolation sound

PARCEL 22



20,766 m<sup>2</sup>  
2.08 ha  
5.13 ac

PROPERTY LINE  
SETBACK LINE  
TOPO ELEVATION (m)



Connect with our property specialist to learn more  
about our remaining parcels in this beautiful location!



# 200M

## Private Beach



A private marina  
with moorage for up to 100'

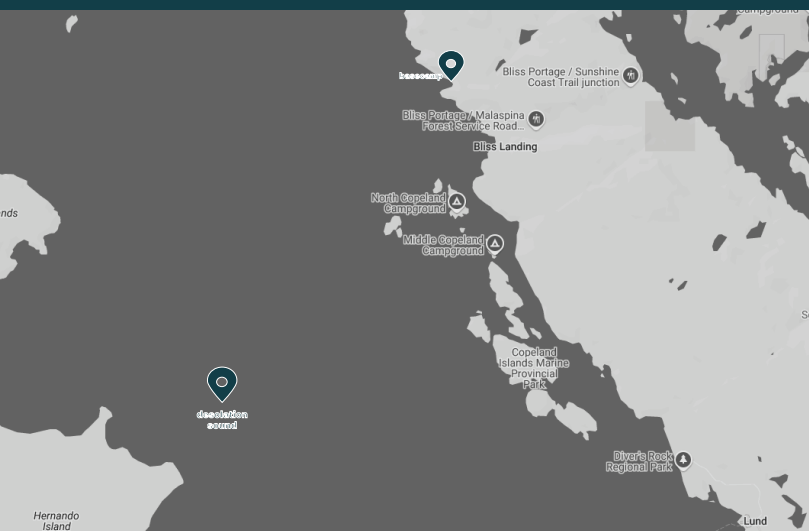
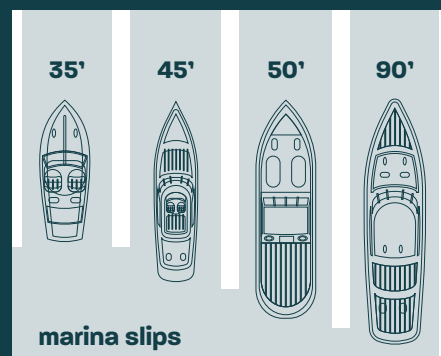

**JASON SOPROVICH**  
LUXURY REAL ESTATE EXCELLENCE

604.817.8812

soprovich.com

jason@jasonsoprovich.com

rennie

"My home is Vancouver,  
my business is Real Estate."



**basecamp**  
**desolation sound**

E&O.E. This is not an offering for sale. Such offerings may only be made with a disclosure statement. Prices are subject to change without notice. The developer reserves the right to make changes and modifications contained herein without notice. Copyright 2025.

Brochure designed by Douglas Creative [www.douglascreative.ca](http://www.douglascreative.ca)